

FIRE NUMBER APPLICATION INSTRUCTIONS

Town of Plum Lake

Page 1 of 2

CONTACT INFORMATION:

- 1) Applicant(s): Give your name, address and telephone contact information
- 2) Land Owner(s): List the property owner as stated on deed or tax bill. Give the property owners name, phone number and address information if it differs from the applicants information.

DRIVEWAY INFORMATION: *(Much of this information can be found on your tax bill)*

- 1) Computer Number: (Found in the upper left corner of your tax bill) Computer number for the parcel of land containing the intersection of the driveway and the road
- 2) Road Name, Side of Road: List the road name and circle the side of the road the driveway is located on.
- 3) Section, Town, Range & Legal Description: List the section, town, range and legal description (NE ¼, NW ¼, GL3, etc) where the driveway and road intersection is located.
- 4) Subdivision plat name, lot, block: Specify the lot, block and subdivision name of the driveway parcel, if applicable.
- 5) Neighbors and intersections: Give the address, distance and directions to the nearest neighbors' driveways or nearest intersections (whichever is closest), measured along the road in both directions.

BUILDING INFORMATION:

- 1) Building type: Give the addressed building type (house, commercial, garage, etc)
- 2) For the rest of the fields, use instructions 1-5 from the driveway information section above. It is only necessary to fill out the fields that differ from the driveway information.

SKETCH: *Draw a sketch of your property as accurately as possible. The sketch should illustrate the following:*

- 1) Features: Illustrate any existing roads & buildings including distances between your primary structure and the driveway/road intersection point.
- 2) Driveway information: Illustrate your driveway and the nearest driveway/road intersection in both directions including distances to the nearest 10 feet
- 3) Miscellaneous information: Road names, labels, explanatory text, etc.

SAMPLE SKETCH

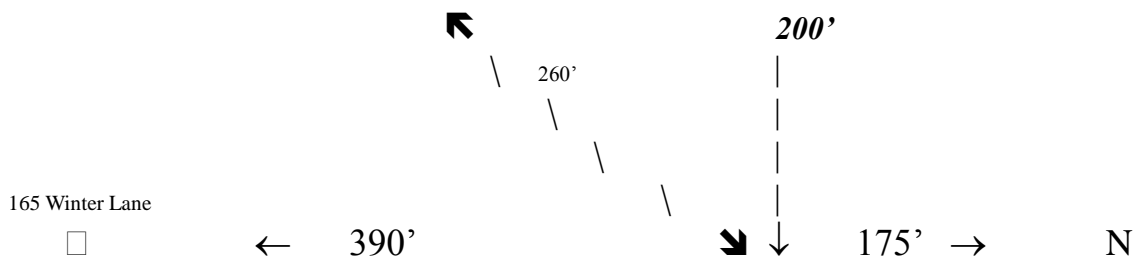

RETURN THIS FORM WITH **\$60.00** FEE TO: **THE TOWN OF PLUM LAKE**
IF YOU HAVE ANY QUESTIONS, PLEASE CONTACT:
The Plum Lake Town Clerk: Phone: 715-542-4531

TOWN OF PLUM LAKE
ADDRESS APPLICATION FORM *Page 2 of 2*

CONTACT INFORMATION:

APPLICANTS NAME: _____ PHONE: _____

ADDRESS: _____ CITY: _____ STATE: _____ ZIP: _____

LANDOWNER(S) NAME: _____ PHONE: _____

ADDRESS: _____ CITY: _____ STATE: _____ ZIP: _____

DRIVEWAY INFORMATION:

COMPUTER #: _____ ROAD NAME: _____ SIDE OF ROAD: N S E W

SECTION: _____ TOWN: _____ RANGE: _____ LEGAL DESCRIPTION: _____

SUBDIVISION NAME: _____ LOT: _____ BLOCK: _____

ADDRESS & DISTANCE FROM YOUR DRIVEWAY TO NEAREST NEIGHBORS DRIVEWAY OR INTERSECTION, IN BOTH DIRECTIONS.

NEIGHBOR #1 ADDRESS: _____ DISTANCE: _____ DIRECTION: _____

NEIGHBOR #2 ADDRESS: _____ DISTANCE: _____ DIRECTION: _____

OR NEAREST INTERSECTION #1: _____ DISTANCE: _____ DIRECTION: _____

OR NEAREST INTERSECTION #2: _____ DISTANCE: _____ DIRECTION: _____

BUILDING INFORMATION:

BUILDING TYPE: _____ COMPUTER #: _____

SECTION: _____ TOWN: _____ RANGE: _____ LEGAL DESCRIPTION: _____

SUBDIVISION NAME: _____ LOT: _____ BLOCK: _____

SKETCH: N

Please Note: If any of the information provided on this application is found to be incorrect, you may be required to change your address.

NAME (PLEASE PRINT): _____ SIGNATURE: _____ DATE: _____